



# SFP-SSP Standing Seam Panel System

## Description

The Sno-Free Heated Standing Seam Panel system is to be used on standing seam roofing. The SFP-SSP easily attaches to each rib to create a large open channel for flowing water to easily continue off the roof. With the cable completely protected within the SFP-SSP system add a custom ramp to the top to help protect the entire system from a slide pulling the system off the roof. Combine the SFP-SSP system with an engineered snow retention system for added protection against slides. The SFP-SSP keeps the aesthetic look of the standing seam roof without any ice dams that could form. All SFP systems come standard with a durable 30 year Kynar finish to match most desired looks.

- Beautifully heats your standing seam cavity at roof eaves.
- Simple to access.
- Attractive and completely hides the wiring along the roof.
- Simple to Install
- Built to match standing seam roof color.
- Adjustable dimensions for any profile.
- Available for all types of Standing Seam roofing.
- Available in Steel, Aluminum, Copper, Cold Roll, etc.

## Applications

For all buildings with a pitch greater than 1/12

### For new roof installations:

Standing Seam Metal

### For installation on existing roofs:

Standing Seam Metal

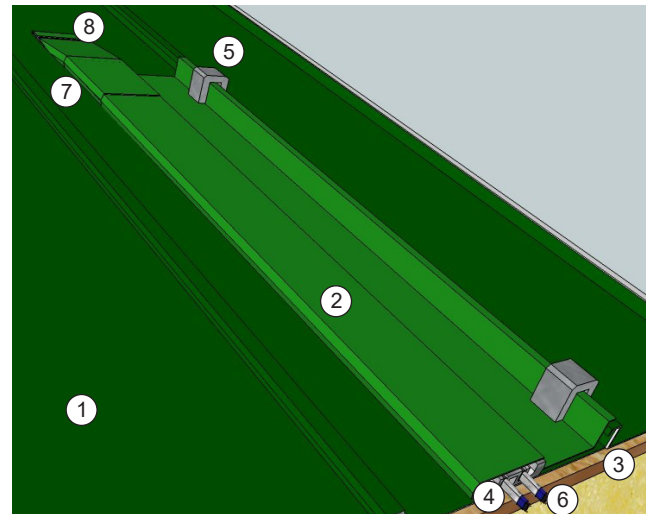
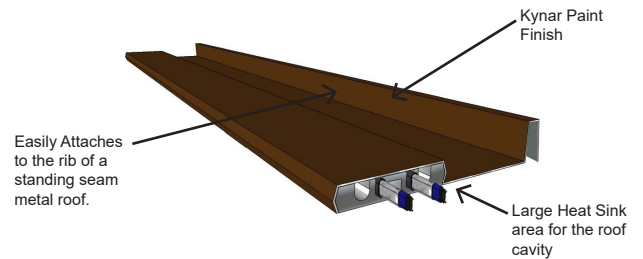

## Key Sections

1. Chosen Standing Seam Roofing Material
2. SFP-SSP-Panel
3. Drip Edge Location
4. 4" Extrusion with 2 Passes of heat cable on both sides of the valley.
5. Attachment Method (S-5 Clip Shown, Direct Screw or Adhesive also approved)
6. 2806-R / 6 Watts per Foot Heat Cable
7. SSP-RAMP for snow Slides
8. Ramp Attachment Clip