

SFP-36 Eave Roof Panel

Description

The SnoFree™ 36" eave roof panel is an efficient method to control any ice dams that would form on a building with an overhang up to 40". With close to 42" of the deck covered, the SFP-36 panel will create all the open area for water to safely flow from the roof without the possibility to refreeze over unheated portions of the roof. The SnoFree™ heated panel system gives an aesthetic look to any structure while keeping a more efficient and cleaner method to eliminate ice dam issues. All SFP systems come standard with a durable 30 year Kynar finish to match most desired looks.

- Effectively controls Ice and Snow with 5 Passes of Cable
- Heats more than 36" up the roof deck
- Comes with a 30 Year protective Kynar finish.
- Sheet metal pieces come in 48" widths for ease of handling.
- An economical and beautiful option to control ice dams for 36" eave overhangs.
- System Parts List:
 - 3—6" Aluminum Extrusion
 - 1—SFP 24 ga. Kynar Steel Lower Base
 - 1—SFP 24 ga. Kynar Steel Upper Base
 - 1—SFP Cleat Drip Edge
 - 1—SFP 24 ga. Kynar Steel Lower Cap
 - 1—SFP 24 ga. Kynar Steel Upper Cap
 - 1—SFP 24 ga. Kynar Steel Lower Exp. Joint
 - 1—SFP 24 ga. Kynar Steel Upper Exp. Joint

Applications

For all buildings with a pitch greater than 4/12

For new roof installations:

- Asphalt Shingle
- Wood Shake Shingles
- Tile or Slate Roofs
- Standing Seam Metal

For installation on existing roofs:

- Asphalt Shingle
- Wood Shake Shingles

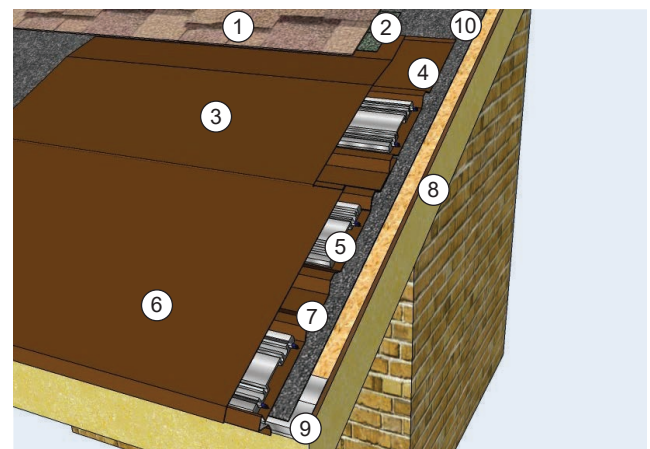
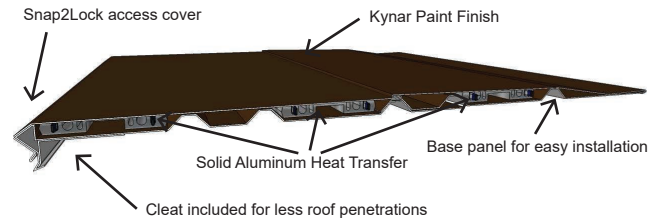

Key Sections

1. Chosen Roofing Material
2. 12" Strip of Ice & Water Barrier
3. Upper SFP-36 Cap
4. Upper SFP-36 Base
5. 3 - 6" Extrusion with 5 Passes of cable
6. Lower SFP-36 Cap
7. Lower SFP-36 Base
8. Structural Roof Sheeting
9. SFP-Cleat
10. Full Roof Water Barrier

