

SFP-Transition and Z Metal

Description

The Sno-Free Transition and Z Metal line is to be used in conjunction with all SFP-Eave Panel Systems. This is the best product to use when installing on existing roofs to make sure that the corresponding shingle course is able to completely cover the panel system without an potential water entry. The transition continues the aesthetic look of the eave panels while keeping the building protected from flowing water. All SFP systems come standard with a durable 30 year Kynar finish to match most desired looks.

- Installs with existing asphalt shingles.
- Comes with a 30 Year protective Kynar finish.
- Sheet metal pieces come in 48" widths for ease of handling.
- Not recommended for wood shake roofs or tile roofs.
- 14" wide transition for easy installation and trimming to desired size.
- System Parts List:
 - 1—24 ga. Kynar Steel Z Metal flashing
 - 1—24 ga. Kynar Steel Transition

Applications

For all buildings with a pitch greater than 4/12

For new roof installations:

- Asphalt Shingle
- Wood Shake Shingles
- Tile or Slate Roofs
- Standing Seam Metal

For installation on existing roofs:

- Asphalt Shingle

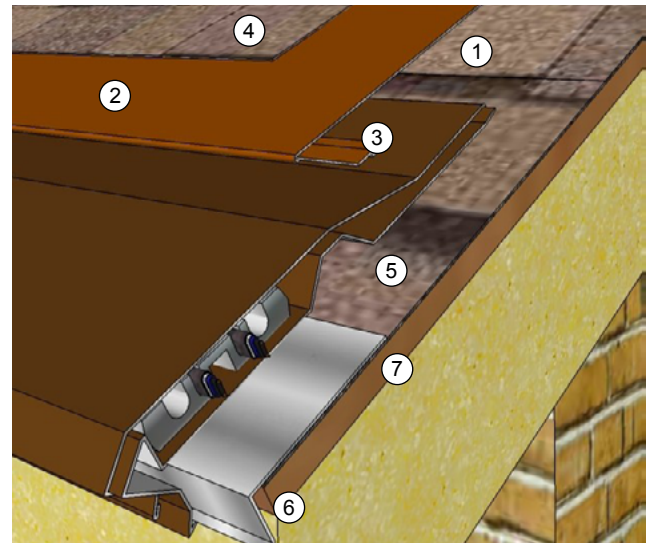
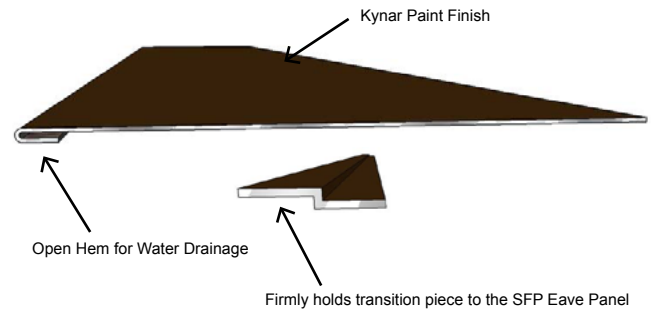

Key Sections

1. Chosen Roofing Material
2. SFP-Transition Cover
3. SFP-Z Metal Attachment
4. Lifted Upper Shingle
5. Lower Shingle Courses
6. Fascia and Existing Drip Edge
7. Structural Roof Sheeting

